

JET

EQUIPMENT & TOOLS

JMA-581 & 582 Mortising Attachment

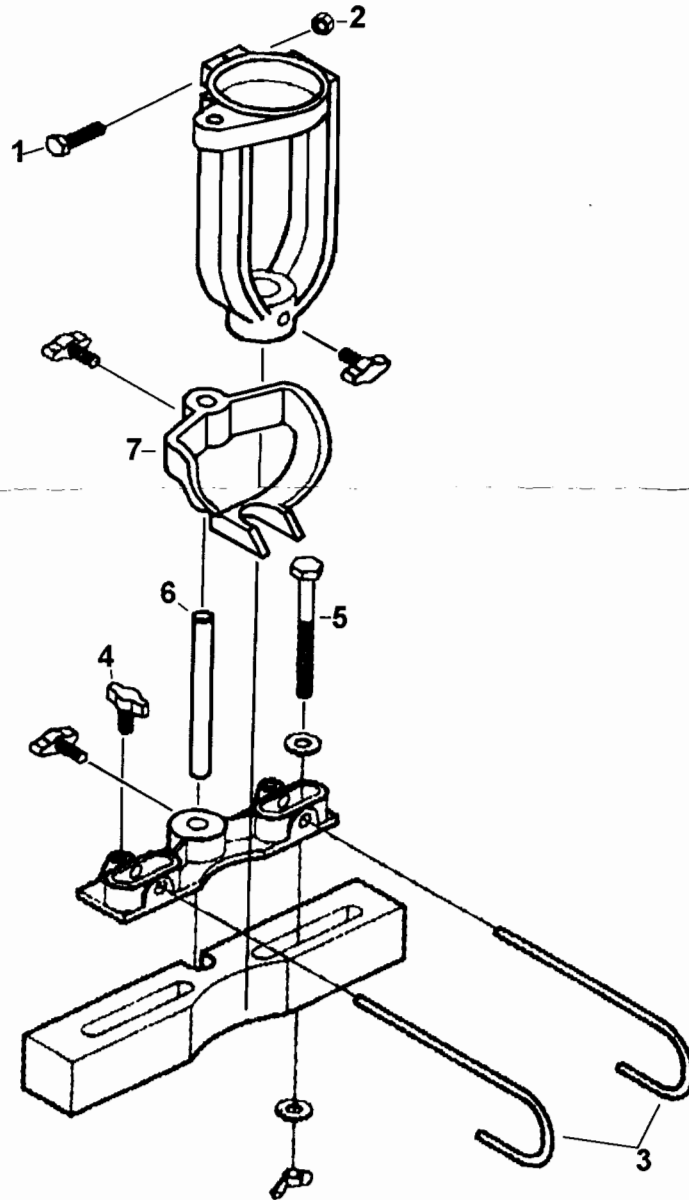

JET EQUIPMENT & TOOLS, INC.
A WMH Company
www.jettools.com

P.O. BOX 1349
Auburn, WA 98071-1349
e-mail jet@jettools.com

253-351-6000
Fax 253-939-8001
M-708581 6/99

⚠WARNING

Always disconnect machinery from power source before making any alterations to equipment. Failure to comply may cause serious injury!

Assembly

1. Insert the bolt (1) through the clamp on the chisel holder.
2. Tighten the nut (2) onto the bolt. Mount the chisel holder over the base of the quill and tighten the nut.
3. Insert the hold down rods (3) through the mortising base.
4. Insert thumbscrews (4) to adjust the hold down rods.
5. Attach the mortising base to the fence using the bolts, washers and wing nuts.
6. The steel rod (6) goes through the main hole of the base. Adjust the rod with the thumbscrew.
7. Attach the frame to the top of the steel rod, and adjust with the thumbscrew.

Mortising Bits & Chisels

Model	Stock No.	Description
MBC-1/4	708590	1/4" Capacity
MBC-5/16	708591	5/16" Capacity
MBC-3/8	708592	3/8" Capacity
MBC-1/2	708593	1/2" Capacity
MBC-3/4	708594	3/4" Capacity
MBC-5	708585	Five Piece Set

Using the Mortiser

Place work piece on the table and adjust the height of the table so the point of chisel clears the work by about a half inch. Run the chisel down along the side of the work to gage the depth of the mortise you want to make. Adjust the depth stop to control the depth of the mortise.

Adjust the hold down rods to hold the work against the fence, tilting the rods if necessary. Lower the hold down arm against the top of the work. These contacts must hold the work in line with light pressure. This will permit sliding the piece across the table. Tighten the hold downs when you have them adjusted properly.

Loosen the wing nuts, which hold the base to the drill press table. This will allow you to move the work piece to the desired position. Tighten wing nuts.

Slide the work piece along the fence to make sure that the cut will be along the desired line. Make sure the chisel is square with the cut. When making a mortise cut start with the extreme ends (far left and right). This will give you a true vertical cut for both ends.

Do not attempt to cut deeper than the rated depth for the chisel. This will not allow the wood chips to clear through the opening in the chisel.